

Your partner in spine surgery

NEURO FRANCE Implants



Spine

2020



+33 (0)2 54 80 90 90



Z.A. «Le Bourg» - 25 rue des Ecoles  
41160 La Ville aux Clercs - FRANCE



[www.neuro-france.net](http://www.neuro-france.net)



Cervical

## ▶ CERVICAL FIXATION

### 1 ) ANTERIOR APPROACH

PM BUTTERFLY® 4

### 2 ) POSTERIOR APPROACH

KM BABY 5

## ▶ CERVICAL FUSION

### 1) PEEK OPTIMA® CAGES

PM CAGE® 6

### 2) TITANIUM CAGES

PM CAGE® 7

## ▶ CERVICAL DISK PROSTHESIS

DYNALIS-C® 8



## ▶ THORACO-LUMBAR FIXATION

### 1 ) ANTERIOR APPROACH

ARTHEMIS	9
----------	---

### 2 ) POSTERIOR APPROACH

G2S®	10
KM	11
CTJ	12
SES +	13

## ▶ THORACO-LUMBAR FUSION

### 1 ) PEEK OPTIMA® CAGES

SHARK	14
PDP	15
BANANA	16

### 2 ) TITANIUM CAGES

SHARK	17
EUROPA®	18
AVENIR	19
BANANA	20

# PM BUTTERFLY®

PLATES FOR ANTERIOR CERVICAL ARTHRODESIS



## ► Indications

- Degenerative spine
- Cervico-brachial neuralgia (myelopathy - radiculopathy).
- Tumor
- Trauma

## ► Contents of the system

- PM BUTTERFLY® anterior cervical plates
- STABILAR® cervical locking or standard screws (Ø 4 mm - L from 10 to 22 mm)

## ► Specifications

**21 sizes of plates, a complete range allowing to adapt to each patient (L 21 mm to L 86 mm - for an arthrodesis of 1 to 5 levels).**

With their **thin profile**, the PM BUTTERFLY® plates reduce the possibility of soft tissue irritation (thickness of the plates : 1,80 mm) while providing anatomical mechanical strength to bending and extension constraints.

The fixation of the implant is secured by a double corporeal screwing and STABILAR® locking screws.





## KM BABY

## CERVICAL ARTHRODESIS



### ► Indications

- Degenerative spine
- Spine deformities
- Tumor
- Trauma

### ► Contents of the system

- KM BABY polyaxial screws (Ø 3,5 mm, 4 mm or 4,5 mm)
- KM BABY Hooks
- Rods (Ø 3mm)
- Connectors & KM BABY cross-links

### ► Specifications

The height of the KM BABY screw heads is 9,85 mm which makes it a low profile system.

The small size of the screws allows the KM BABY system to adapt perfectly to the cervical spine.



# PM CAGE® PEEK OPTIMA®

ANTERIOR CERVICAL INTERBODY FUSION CAGE



## ► Indications

- Cervico-brachial neuralgia
- Degenerative spine

## ► Contents of the system

- PM CAGE® cervical cage in PEEK OPTIMA®

## ► Specifications

The **8 heights in both two widths** and the lordotic profile of the cages allow an optimal adaptation to the anatomy of each patient.

The PM CAGE® implant has a large opening for a maximum graft surface. The PM CAGE® implant has two titanium alloy Ti 6-Al 4-V markers .

The cages are optionally available in sterile or non-sterile packaging.

PEEK OPTIMA® is a perfectly biocompatible, resistant material allowing to rapid osseointegration.

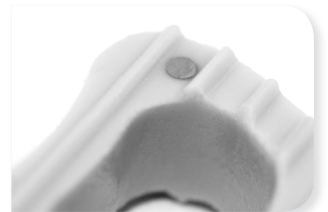

# PM CAGE® TITANIUM

ANTERIOR CERVICAL INTERBODY FUSION CAGE



## ► Indications

- Cervico-brachial neuralgia
- Degenerative spine

## ► Contents of the system

- PM CAGE® cervical cage in **TITANIUM alloy Ti 6-Al 4-V**

## ► Specifications

The **8 heights in both two widths** and the lordotic profile of the cages allow an optimal adaptation to the anatomy of each patient.

The PM CAGE® implant has a large opening for a maximum graft surface.

The cages are only available in non-sterile packaging.

Titanium alloy Ti 6-Al 4-V is a widely used material for the manufacture of surgical implants. It is perfectly biocompatible, resistant and adapted to modern medical imaging.





### ► Indications

- Cervico-brachial neuralgia (myelopathy - radiculopathy)
- Degenerative disk disease

### ► Contents of the system

- Titanium alloy Ti 6-Al 4-V cervical disk prosthesis with a PEEK OPTIMA<sup>®</sup> core

### ► Specifications

The DYNALIS-C<sup>®</sup> cervical disk prosthesis allows the patient to maintain complete mobility of the cervical spine without articular constraint.

The prosthesis offers a double fixation :

- primary fixation thanks to the "shark" teeth
- secondary fixation thanks to its titanium plasma coating

The DYNALIS-C<sup>®</sup> disk prosthesis is available in sterile packaging only.

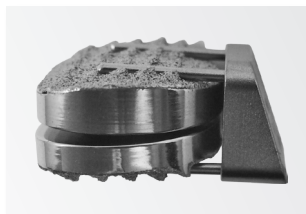
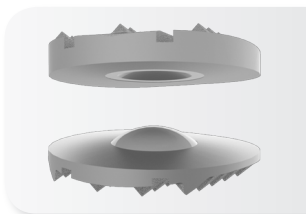

# ARTHEMIS

PLATES FOR TOTAL OR PARTIAL CORPECTOMY



## ► Indications

- Trauma
- Tumor

## ► Contents of the system

- ARTHEMIS plates (thoracic : from L 50 to 80 mm or lumbar : from L 80 to 125 mm)
- ARTHEMIS locking screws (Ø 5,5 mm or Ø 6,5 mm)

## ► Specifications

Intervertebral plate fixation system for total or partial corpectomy.

The different plate sizes allow fixation of one or more intervertebral spaces.

The ARTHEMIS plates fit perfectly to the spine. Two plate designs are available. A wide one for the lumbar plates, a smaller one for the thoracic plates.

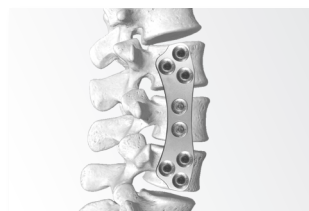



► Indications

- Degenerative spine
- Spine deformities
- Tumor
- Spine trauma

► Contents of the system

- G2S® monoaxial, polyaxial and spondylolisthesis screws
- Cannulated or uncannulated screws
- Hooks
- Precurved & straight rods Ø 5 & 5,5 mm
- Articulated cross-links
- Rod connectors
- Ilio-sacral connectors
- PANCOAST\* connectors

► Specifications

The G2S® screws have a double threading :

- the **Sblock®**; an intra-pedicular threading that enhances bone healing thanks to its atraumatic profile
- a cortico-cancellous threading that combined with the **Sblock®** threading, provides high pull out resistance and early mobilization of the patient.

\*For more information on PANCOAST connectors, refer to the ThoRib® commercial brochure.



## THORACO-LUMBAR FIXATION SYSTEM



### ► Indications

- Degenerative spine
- Spine deformities
- Tumor
- Spine trauma

### ► Contents of the system

- Polyaxial or monoaxial screws
- Spondylolisthesis monoaxial or polyaxial screws
- KM hooks
- Round or hexagonal end rods  $\varnothing$  5, 5,5 & 6 mm
- Articulated cross-links
- Cylindrical connectors

### ► Specifications

The KM system has reliable clinical experience since it has been distributed in France and internationally for more than 10 years.

Associated to CTJ thoracic screws (*p.12*), the KM system allows for long constructs adapted to reductions in scoliosis.

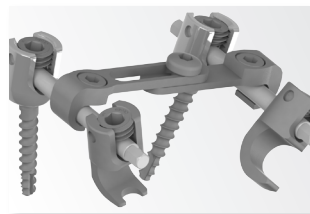
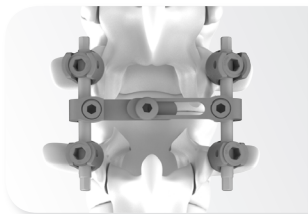



### ► Indications

- Degenerative spine
- Spine deformities
- Tumor
- Trauma

### ► Contents of the system

- CTJ thoracic monoaxial screws
- CTJ thoracic polyaxial screws
- CTJ hooks
- Rods Ø 5 mm
- Articulated cross-links
- Cylindrical connectors
- Square connectors
- PANCOAST\* connectors

### ► Specifications

The design of the CTJ screw heads has been specially designed to guarantee the comfort of the patient. In fact, the low-profile tulip screw avoids irritation of the tissues of the cervico-thoracic area.

The CTJ screws are used in addition to the KM system (p.11) for long constructs.

*\*For more information on PANCOAST connectors, refer to the ThoRib® commercial brochure.*

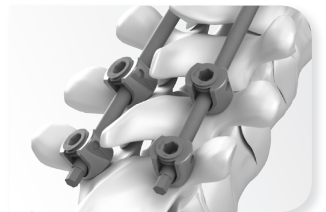





► Indications

- Degenerative spine
- Trauma
- Spine deformities

► Contents of the system

- SES+ screws Ø 5,5 mm to 7,5 mm
- 3D washer & nut
- SES+ hooks
- Ø 5,5 mm precurved or straight rods
- Articulated cross links
- Connectors

► Specifications

SES + is particularly adapted to the reduction of scoliosis.

SES + system allows to implant 2 rods on the same pedicle line, side by side, thanks to its connector hook. This allows to strengthen an area of the construct with a total of 4 rods.

The SES + screws are also easily removable during the surgery (even after the extension has been broken off thanks to its two shoulders and its adapted instrument set).

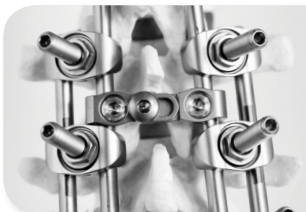

## SHARK® PEEK OPTIMA®

P.L.I.F/T.L.I.F INTERBODY FUSION CAGE FOR VERTEBRAL ARTHRODESIS



► Indications

- Degenerative spine
- Spine deformities
- Trauma

► Contents of the system

- SHARK cages in PEEK OPTIMA®

► Specifications

The SHARK cages have a constant width (10 mm) for all cage heights. This allows the introduction to be secured by limiting the distraction of the nervous elements.

The implant has anti-expulsion teeth to ensure the stability of the implant in the interbody space. The implant also has titanium alloy Ti 6-Al 4-V markers.

The SHARK cage makes it possible to recreate a lordosis thanks to its domed shape.

The large internal opening of the cage allows a successful bone graft.

The SHARK cage is available in sterile or non-sterile packaging.





### ► Indications

- Degenerative spine
- Spine deformities
- Trauma

### ► Contents of the system

- PDP cages in **PEEK OPTIMA®**

### ► Specifications

Unilateral arthrodesis (U.N.I.L.I.F.) significantly reduces operating time, bleeding and irradiation from the C-arm. This technique also protects the nervous elements.

The PDP interbody fusion cage restores the discal space and the lordosis (between 6.2° and 8°). The teeth provide a strong primary fixation and removes any risk of mobility of the implant. The implant has two titanium alloy Ti 6-Al 4-V markers.

The 11 sizes of cages available make it possible to adapt to each patient (L 26 mm, 32 mm or 36 mm / H 9 mm, 10 mm, 12 mm or 14 mm).

The PDP cages are available in sterile or non-sterile packaging.



## BANANA PEEK OPTIMA®

UNI.L.I.F. / T.L.I.F. INTERBODY FUSION CAGE



## ▶ Indications

- Degenerative spine
- Spine deformities
- Trauma

## ▶ Contents of the system

- BANANA cages in PEEK OPTIMA®

## ▶ Specifications

The shape of the BANANA cage allows the user to easily penetrate the discal space through a natural pathway between the nerve structures.

The BANANA cage provides excellent bone fusion support thanks to its large grafting surface.

The BANANA implant has three titanium alloy Ti 6-Al 4-V markers .

The BANANA implant guarantees the stability of the restored discal space thanks to its anti-expulsion teeth.



## SHARK® TITANIUM

P.L.I.F./T.L.I.F INTERBODY FUSION CAGE FOR VERTEBRAL ARTHRODESIS



### ► Indications

- Degenerative spine
- Spine deformities
- Trauma

### ► Contents of the system

- SHARK cages in TITANIUM alloy Ti 6-AL 4-V

### ► Specifications

The SHARK cages have a constant width (10 mm) for all cage heights. This allows the introduction to be secured by limiting the distraction of the nervous elements.

The implant has anti-expulsion teeth to ensure the stability of the implant in the interbody space.

The SHARK cage makes it possible to recreate a lordosis thanks to its domed shape.

The large internal opening of the cage allows a successful bone graft.

The SHARK cage is available only in non-sterile packaging.





### ► Indications

- Degenerative spine
- Spinal deformities
- Trauma

### ► Contents of the system

- EUROPA® cages in TITANIUM alloy Ti 6-AL 4-V

### ► Specifications

The domed shape of the cage makes it possible to restore the lordosis. The EUROPA® cage is self-distracting. Indeed, once the cage is inserted, following a rotational movement, it allows a distraction of 2 mm.

The large internal opening and the multiple lateral holes ensure a large grafting surface both between the vertebral bodies and between the two cages.

The teeth guarantee a good anchoring of the cage.





### ► Indications

- Degenerative spine
- Spine deformities
- Trauma

### ► Contents of the system

- AVENIR cages in TITANIUM alloy Ti 6-AL 4-V

### ► Specifications

Unilateral arthrodesis (U.N.I.L.I.F.) significantly reduces operating time, bleeding and irradiation from the C-arm. This technique also protects the nervous elements.

The AVENIR interbody fusion cage restores the discal space and the lordosis (between 6.2° and 8°). The teeth provide a strong primary fixation and remove any risk of mobility of the implant.

The 11 sizes of cages available make it possible to adapt to each patient (L 26 mm, 32 mm or 36 mm / H 9 mm, 10 mm, 12 mm or 14 mm).



# BANANA TITANIUM

## UNI.L.I.F. / T.L.I.F. INTERBODY FUSION CAGE



### ► Indications

- Degenerative spine
- Spine deformities
- Trauma

### ► Contents of the system

- BANANA cages in TITANIUM alloy Ti 6-Al 4-V

### ► Specifications

The shape of the BANANA cage allows the user to easily penetrate the discal space through a natural pathway between the nerve structures.

The BANANA cage provides excellent bone fusion support thanks to its large grafting surface.

The BANANA implant guarantees the stability of the restored discal space thanks to its anti-expulsion teeth.







A page of lined paper with horizontal dotted lines for writing. The lines are spaced evenly down the page. There is a vertical orange line on the left side of the page, near the top left corner.

*Posterior*

APPROACH

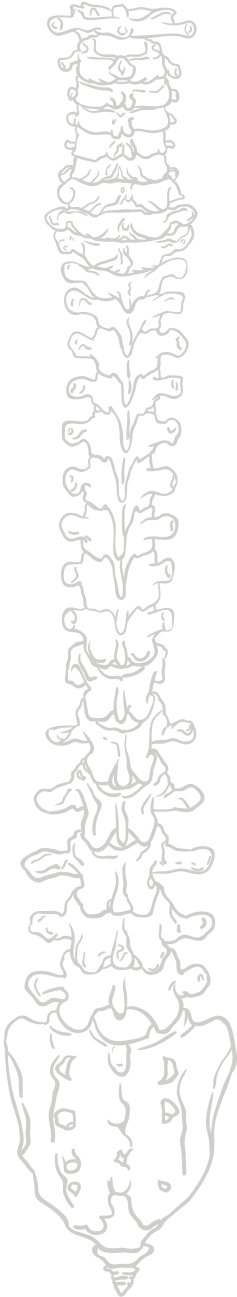

KM BABY

CTJ

KM

G2S®

SES+

AVENIR

PDP

BANANA

SHARK

EUROPA®

*Anterior*

APPROACH

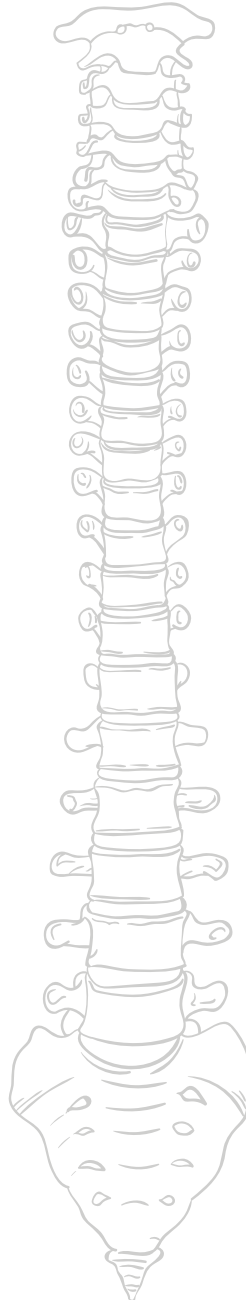

DYNALIS-C®

PM CAGE®

PM BUTTERFLY®

ARTHEMIS

Your partner in spine surgery

NEURO FRANCE Implants



Spine



Your partner in spine surgery

NEURO FRANCE Implants



Spine

Z.A. «Le Bourg» - 25 rue des Ecoles

41160 La Ville aux Clercs - FRANCE

Phone : +33 (0)2 54 80 90 90 / Fax : +33 (0)2 54 80 83 33

neurofrance@neuro-france.net

[www.neuro-france.net](http://www.neuro-france.net)